

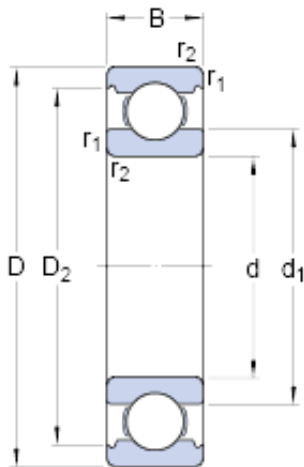

China abec 9 Bearing Supplier



6207 Bearing 2D drawings and 3D CAD models

SKF bearing Made in france SKF 6207 6206 6205
6204 6203 6202 6201 bearings

Bearing No. 6207

Size	72x35x17 mm
Bore Diameter	72 mm
Outer Diameter	35 mm
Width	17 mm
d	35 mm
D	72 mm
B	17 mm
d ₁	46.94 mm
D ₂	62.69 mm
r _{1,2} - min.	1.1 mm
d _a - min.	42 mm
D _a - max.	65 mm
r _a - max.	1 mm
Basic dynamic load rating - C	27 kN
Basic static load rating - C ₀	15.3 kN
Fatigue load limit - P _u	0.655 kN
Reference speed	20000 r/min
Limiting speed	13000 r/min
Calculation factor - k _r	0.025
Calculation factor - f ₀	13.8
Category	Single Row Ball Bearings
Inventory	0.0
Manufacturer Name	SKF
Minimum Buy Quantity	N/A



China abec 9 Bearing Supplier

Weight / Kilogram	0.293
EAN	7316577067449
Product Group	B00308
Enclosure	Open
Precision Class	ABEC 1 ISO P0
Maximum Capacity / Filling Slot	No
Rolling Element	Ball Bearing
Snap Ring	No
Internal Special Features	No
Cage Material	Steel
Internal Clearance	C0-Medium
Inch - Metric	Metric
Long Description	35MM Bore; 72MM Outside Diameter; 17MM Outer Race Diameter; Open; Ball Bearing; ABEC 1 ISO P0; No Filling Slot; No Snap Ring; No Internal Special Features
Category	Single Row Ball Bearing
UNSPSC	31171504
Harmonized Tariff Code	8482.10.50.68
Noun	Bearing
Keyword String	Ball
Manufacturer URL	http://www.skf.com
Manufacturer Item Number	6207
Weight / LBS	0.64
Outside Diameter	2.835 Inch 72 Millimeter
Outer Race Width	0.669 Inch 17 Millimeter
Bore	1.378 Inch 35 Millimeter
d ₁	46.94 mm
D ₂	62.69 mm
r _{1,2} min.	1.1 mm



China abec 9 Bearing Supplier

d_a min.	42 mm
D_a max.	65 mm
r_a max.	1 mm
Basic dynamic load rating C	27 kN
Basic static load rating C_0	15.3 kN
Fatigue load limit P_u	0.655 kN
Calculation factor k_r	0.025
Calculation factor f_0	13.8
Mass bearing	0.29 kg